

BLACKVUE

ELITE + **GOLD** Series Quick Start Guide



Table of Contents

1. What's In the Box

- Standard components

2. Product Overview

- Product layout

3. Installation

- Dashcam Installation guide

4. Playing and Managing Videos

- Using the BlackVue App

5. Product Specifications







- Specifications

1. What's In the Box

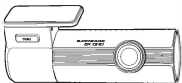
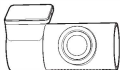
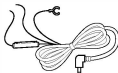
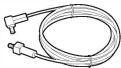
Get to know what's included with your ELITE + GOLD dashcam and which accessories you can add.

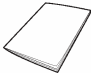
Standard components

Check the box for each of the following items before installing the Blackvue Dashcam.

	Front Camera		Rear Camera
	Hardwiring Power Cable		Rear Camera connection cable (2CH Only)
	Micro SD Card		Quick Start Guide
	Double-side tape for the Front Camera mounting brackets		Double-side tape for the Rear Camera mounting brackets (2CH Only)
	Cable clips 1CH : 3 EA 2CH : 5 EA		

2. Product Overview

Product Layout

Front camera (Front side)

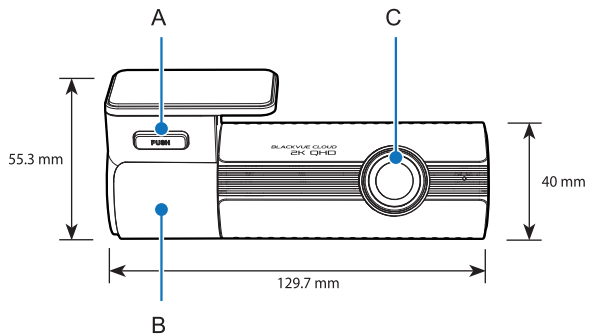

- A) PUSH Button
- B) Mount Bracket
- C) Camera Lens

Front camera (Rear side)

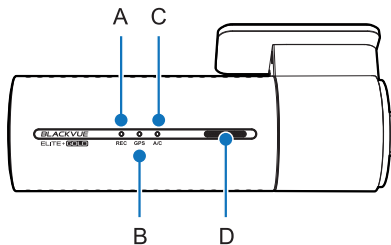

A) Recording LED

● : Lights red is Boot up and Recording mode.

Recording mode like below:

Normal Recording / Manual Recording / Event Recording /
Time-Lapse in Parking / Motion in Parking.

B) GPS LED

● : Lights Blue when GPS on.

C) APP/CLOUD

● : Lights yellow when BT and Wi-Fi paired.

○ : Lights white when Cloud connects.

●●● : Blinks red / blue / white quickly when Reset SD card / Micro SD
card and error / Firmware Upgrade.

D) Speaker

Front camera (Right side)

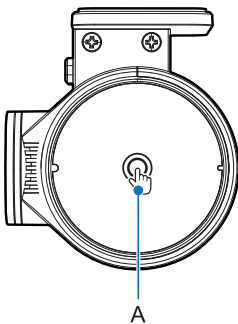

A) Touch Sensor

Press the sensor to trigger a manual recording.

-Touch sensor can be turned on/off in the firmware setting

Front camera (Left side)

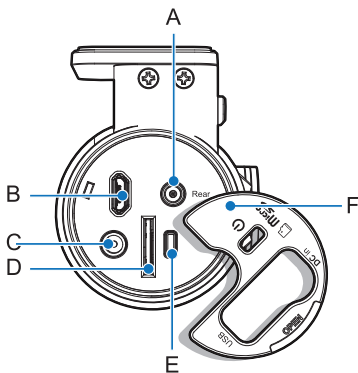

A) Rear camera connection port

B) Micro USB Port

C) DC in (Power connector)

D) micro SD card slot

E) Power Button

-Press and hold for 3 seconds to Power off the camera

-Press the button again to power it on

 Note: The camera cannot be powered on while the vehicle's ACC is off.

F) Cover

Removing and inserting the bracket for Front Camera

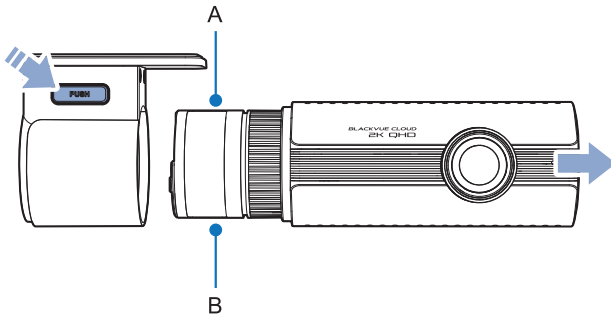

PUSH button

- 1) To remove the dashcam from its bracket , press the PUSH button and pull the dashcam out of the mounting.
- 2) To insert the dashcam into its bracket , push the dashcam into the mounting bracket until click in.

Font camera Label information

- A) Connectivity details label:Default Wi-Fi SSID / Default Wi-Fi password / Product Serial Number
- B) Certification label: RCM

Rear camera (ELITE + GOLD-2CH Only)

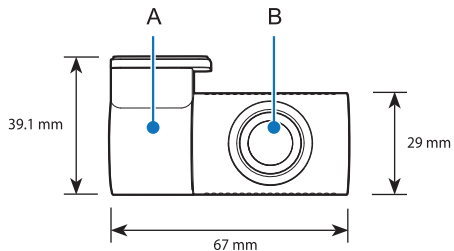

A) Mounting bracket

B) Camera lens

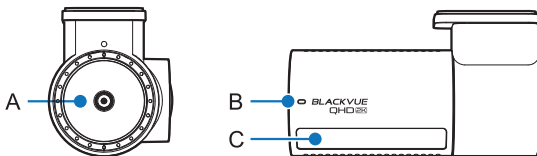

A) V out(Front camera connection port)

B) Rear security LED

C) Certification label: CE / FCC / ROHS / WEEE

Removing and inserting the bracket for Rear Camera
(ELITE + GOLD-2CH Only)

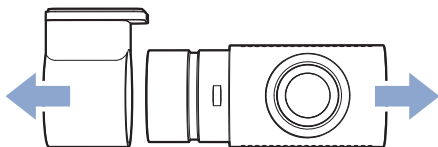

- 1) To remove the rear camera from its bracket, hold the mounting bracket and pull the rear camera out.
- 2) To insert the rear camera into its bracket, push the rear camera into the mounting bracket until it “clicks” in.

3. Installation

Dashcam Installation Guide

⚠ Before You Begin

- **Choose installation locations carefully:**
 - **Front camera:** Behind the rearview mirror.
 - **Rear camera:** At the top center of the rear windshield.
- **Clean the windshield:** Remove any dust, oil, or moisture before sticking the cameras.
- **Peel off the protective film** from both front and rear cameras to prevent overheating.
- **Do not install** the cameras where they might block the driver's view.

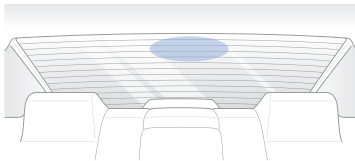

📝 Note for ELITE + GOLD-1CH users: The rear camera is optional.

Step-by-Step Installation

▪ Step1. Insert the microSD Card

- Turn off the vehicle engine.
- Open the microSD card slot cover on the front camera.
- Gently insert the card until it clicks into place and close the cover.

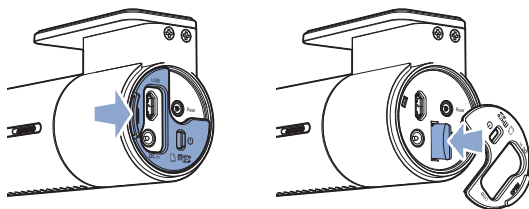

▪ Step2. Mount the Front Camera

- Remove the double-sided tape.

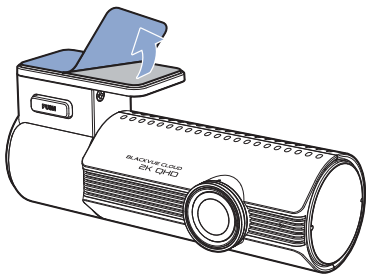

- Attach the front camera to the windshield, behind the rearview mirror.

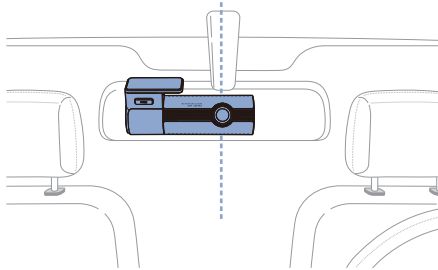

- Adjust the lens angle by rotating the camera body.

💡 Tips: Tilt the lens slightly downward ($\sim 10^\circ$) for a 6:4 road-to-sky ratio.

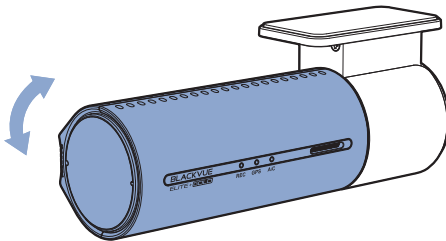

▪ **Step3. Mount the Rear Camera (if applicable)**

- Peel off the tape film and stick the rear camera to the rear windshield.
- Rotate the camera body to adjust the viewing angle.

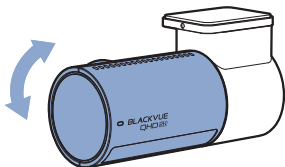

▪ **Step4. Connect the Front and Rear Cameras**

- Use the provided rear camera cable:
 - Plug one end into the 'Rear' port of the front camera.
 - Plug the other into the 'V out' port of the rear camera.

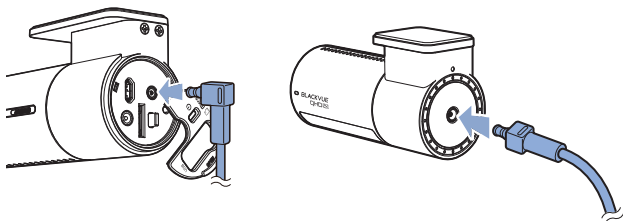

▪ **Step5. Hide the Rear Camera Cable**

- Use the pry tool to gently lift window moldings or rubber seals.
- Tuck the cable neatly along the edges for a clean look.

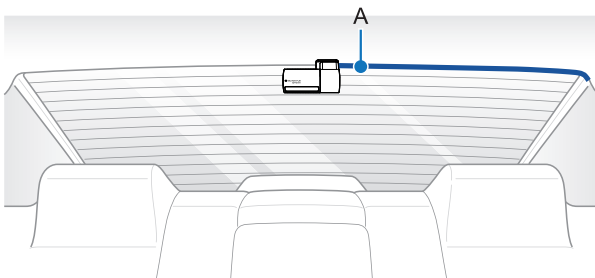

A): Rear camera cable

▪ Powering Your Dashcam

You can power your BlackVue dashcam in three main ways. Choose the option that matches your vehicle's compatibility.

Using the Hardwiring Power Cable

- 1) Locate your vehicle's fuse box (check your car manual if unsure).
 - 2) Remove the fuse box cover and identify:
 - 3) A fuse that powers **on with the engine** (e.g. audio, cigarette lighter) – connect **ACC+** here.
 - 4) A fuse that's **always powered** (e.g. hazard lights, dome light) – connect **BATT+** here.
- 💡 **Tips:** For parking mode and battery protection, connect **BATT+** to the hazard light fuse.
- 5) Connect the **GND (ground)** wire to a metal bolt on the vehicle frame.
 - 6) Plug the power cable into the front camera's **DC in** port. The dashcam will power on and start recording.

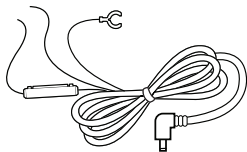

4. Playing and Managing Videos

Using the BlackVue App

▪ Register BlackVue Account

1) Download the App

Search for "BlackVue" on the Google Play Store or Apple App Store and install the app on your smartphone.

2) Create an Account

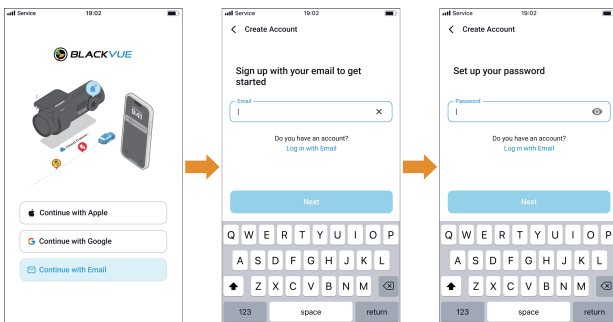

- Open the app. On the welcome screen, choose a sign-up method:
 - Continue with Apple
 - Continue with Google
 - Continue with Email

• If you choose Continue with Email:

1. **Enter your email address**

Type in your email address and tap **Next**.

2. **Create a Password**

Set a secure password for your account and tap **Next**.

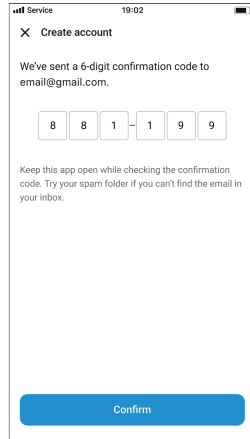
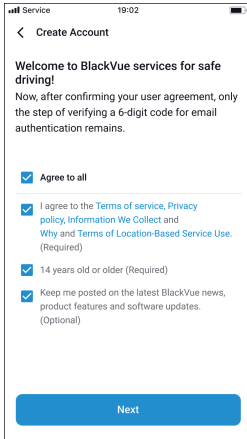

3. **Agree to Terms**

- Accept the Terms of Service and Privacy Policy
- Confirm that you are 14 years of age or older
- (Optional) Subscribe to product news and updates Tap Next to continue.

4. **Verify your Email**

- A 6-digit confirmation code will be sent to your email.
- Enter the code and tap **Confirm** to complete your registration.

▪ Add BlackVue Dashcam to Camera List

You can add your camera using one of the following methods:

1) Seamless Pairing (BT)

- Getting Started: Select the "+" icon or tap "Add Camera" to begin the setup.
- For seamless pairing, ensure your smartphone's Bluetooth is enabled.
- Make sure the dashcam is powered on and nearby.
- Tap **Seamless Pairing (BT)** and select your camera.
- Follow the on-screen instructions to verify your dashcam by placing your hand on the touch sensor.
- Once verified, the camera is registered automatically.
- Configure options like Wi-Fi/FTA, Cloud Storage, and Battery Pairing.

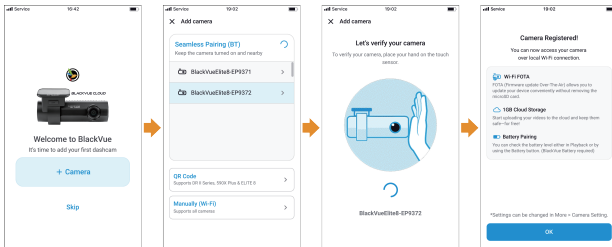

2) Add with QR Code

- Tap Add with QR Code.
- Allow camera access if prompted.

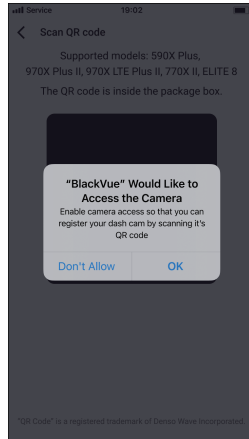
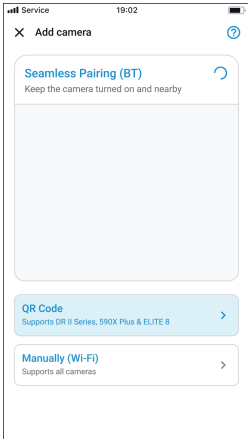

- Scan the QR code located on its packaging.
- Once the QR code is recognized, your dashcam will be registered automatically.
- On the Camera Registered screen, configure the following options as needed:
 - Wi-Fi/FTA: Enable wireless features.
 - Cloud Storage: Automatically upload footage to the cloud.
 - Battery Pairing: Link with a compatible BlackVue Battery (if applicable).
- Tap OK to finish the setup.

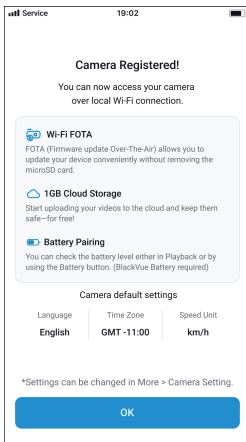

3) Manually (Wi-Fi)

- Tap Manually (Wi-Fi).
- Enter your dashcam's Wi-Fi SSID and password.
- Connect your smartphone to the dashcam's Wi-Fi.
- Your camera will then be added to the app.

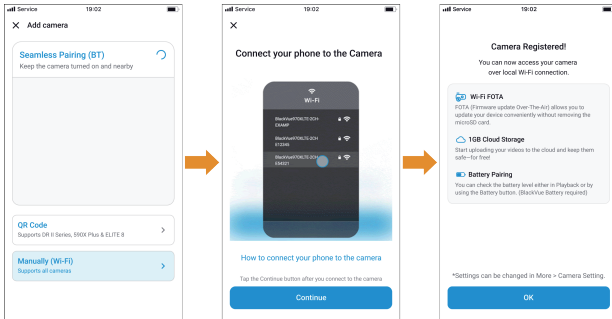

💡 Tips: You can always revisit or change these settings later from the **Camera Settings** menu.

▪ **Playing Video**

Accessing Recorded Videos

- 1) Open the **BlackVue** app on your smartphone.
- 2) On the **Cameras** tab, tap your dashcam model from the list.
- 3) Select **“Playback / Live View”** to open the SD Card Video screen.

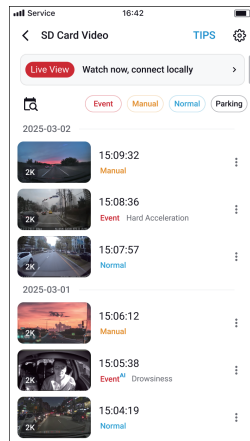
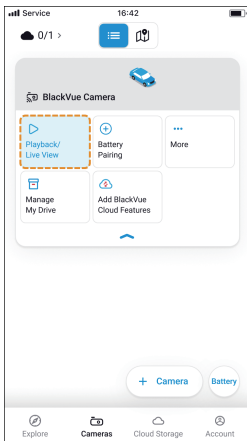

Playing a Video in the playback

- 4) Scroll through the list to find the video you want to view.
- 5) Tap on a video thumbnail to start playback.
- 6) While playing, the **date**, **time**, **recording type**, and **speed** (if GPS is enabled) will be displayed on screen.

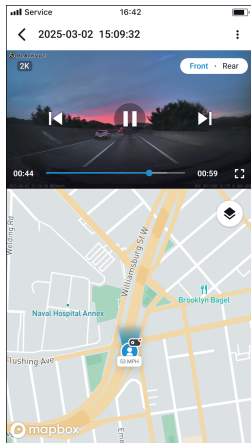

SD Card Video Layout

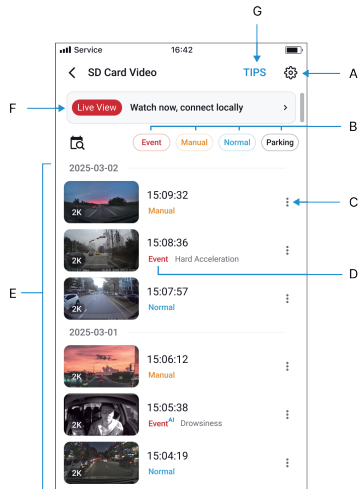

- A) Camera Settings
- B) File type filter
- C) Video file menu
- D) File type
- E) Video list
- F) Live View
- G) TIPS

Identify video files by recording type

Normal	Normal	The dashcam records in normal mode by default.
Event	Event	When the dashcam detects an impact while in normal or parking mode, it switches to event mode and saves an event recording beginning 5 seconds before the event triggers. Exceeding the set speed limit will also trigger an event recording.
Parking	Parking	In parking mode the dashcam continuously buffers video. When motion is detected in the dashcam's field of view, it saves a parking recording beginning 5 seconds before the motion detection.
Manual	Manual	If touch sensor is enabled in the firmware settings, touching the sensor will trigger manual recording.

▪ Live View

Check what your dashcam sees in real time — ideal for setup, positioning, or remote viewing.

SD Card Video Layout

- 1) Open the BlackVue app and go to your Camera screen.
- 2) Tap “Playback / Live View”.
- 3) Select the “Live View” tab at the top of the SD Card Video screen.
 - Make sure your smartphone is connected to the dashcam's Wi-Fi or Cloud, depending on your setup.

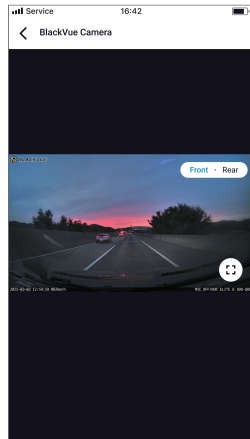
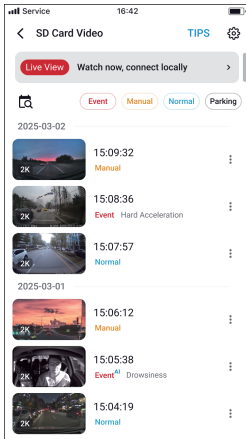

4) The live video stream from your dashcam will appear.

- You can switch between Front and Rear views (if supported).
- Use this to help with dashcam installation or to check your vehicle remotely via Cloud connection.

 **Note:** A stable Wi-Fi or Cloud connection is required for smooth real-time viewing.

5. Product Specifications

Model	ELITE + GOLD-1CH / 2CH
Dimensions & Weight	Front: 129.7 × 55.3 mm (5.11 × 2.18 in) / 203.2 g (0.45 lb) Rear: 29 × 39.1 mm (1.14 × 1.54 in) / 38.8 g (0.09 lb)
Color	Front: Black with Gold Accent Rear: Black
Image Sensor	Sony STARVIS 2, 5 Megapixel (Front & Rear)
Lens	F2.0, 6G + 1 IR (Front & Rear)
Viewing Angle	Diagonal 142° / Horizontal 118° / Vertical 62°
Resolution / Frame Rate	2K QHD @30fps (Front & Rear)
HDR	Dual HDR (Front & Rear)
Video Codec	H.264 (MP4)
Recording Modes	Normal Recording Event Recording: Impact, Overspeed, Hard Accel/Brake/Cornering (10s Pre-buffer) Parking Mode: Power Saving (≤1mA), Motion Detection, Time-lapse
File Protection	Up to 50 event files protected from overwrite
Storage	BlackVue microSD (64GB ~ 1TB), Adaptive Format-Free
Connectivity	Wi-Fi 5 (2.4GHz / 5GHz) Bluetooth v2.1+EDR / 5.3 GPS: Built-in (GPS + GLONASS) LTE: via Optional Module
Power Input	DC 12V–24V (3 pole DC Plug Ø3.5×Ø1.1)
Power Consumption	1CH: 340mA (Normal), 297mA (Parking) 2CH: 500mA (Normal), 416mA (Parking) Power Saving Mode: ≤1mA

Protection System	Built-in Supercapacitor Timer Cut-off: 1–48h Low Voltage Cut-off: 11.8–12.5V / 22.8–24V High Temp Cut-off: 70 °C (158°F)
Audio & Indicators	Built-in Mic & Speaker (Voice Guidance) Front LEDs: Recording, GPS, App/Cloud Rear LED: Security
Operating Temperature	-20 °C ~ 65 °C (-4°F ~ 149°F)
Storage Temperature	-20 °C ~ 80 °C (-4°F ~ 176°F)
Software & Cloud	BlackVue App (Android 10+, iOS 15+) FLEETA App & Web Viewer (Chrome/Edge/Safari) Free Cloud Backup (1GB)
Certifications	Front: RCM Rear: FCC, IC, CE, RoHS, WEEE

Notes



Product	Dashboard Camera
Model Name	ELITE + GOLD 1CH, ELITE + GOLD 2CH
Manufacturer	Pittasoft Co., Ltd.
Headquarter	4F ABN Tower, 331, Pangyo-ro, Bundang-gu, Seongnam-si, Gyeonggi-do, Republic of Korea, 13488
Customer Support	cs@pittasoft.com
Australia Distributor	Auto BlackBox Pty Ltd
Address	13 Pearson Way, Osborne Park, Western Australia, 6017
Technical Support	support@blackvue.com.au
Telephone	1300 967 777
Product Warranty	Two-Year Limited Warranty

facebook.com/BlackVueOfficial
 instagram.com/BlackVueOfficial
 youtube.com/BlackVueOfficial
 www.blackvue.com

Made in Korea

COPYRIGHT © 2025 Pittasoft Co., Ltd. All rights reserved.